

# Maker.



# About.

---

## INTRODUCTION TO MAKER

---

Maker is an innovative, multipurpose table system designed and developed by VE Furniture.

Makerspaces are places where people come together to collaborate and learn new skills.

These environments are as unique as the people who work in them. They require flexible and customized solutions that can accommodate their unique needs.

Maker provides options that empower students to sit, stand, focus, collaborate, make and learn. With surfaces and storage solutions that are as flexible as the the lesson being taught.

Maker is the perfect collection of products to create makerspaces and learning environments that support hands on learning.

This guide contains multiple products from the Maker Table range which have been curated into one specification guide for your convenience. Note that each product may be subject to different pricing terms and conditions based on finishes selected.

Phone \_ 1300 966 640  
Email \_ [info@vef.com.au](mailto:info@vef.com.au)  
Web \_ [vef.com.au/maker](http://vef.com.au/maker)



# Index.

---

**STORAGE PROFILES**

---

**MAKER COMPONENTS**

---

**MATERIALS + FINISHES**

---

**SHIPPING + WARRANTY**

---

# Maker

## MAKER FLEXIBLE LEG + STORAGE PROFILES

Multiple base and frame options provide options for every area of learning.

Maker's flexible storage plinth design can be configured with a range of accessories including tote boxes, drawers, doors, cabinets and open shelving.

Lockable castors make moving tables a breeze and the optional raised edge profile ensures nothing falls from the table when designing, building, creating and testing.

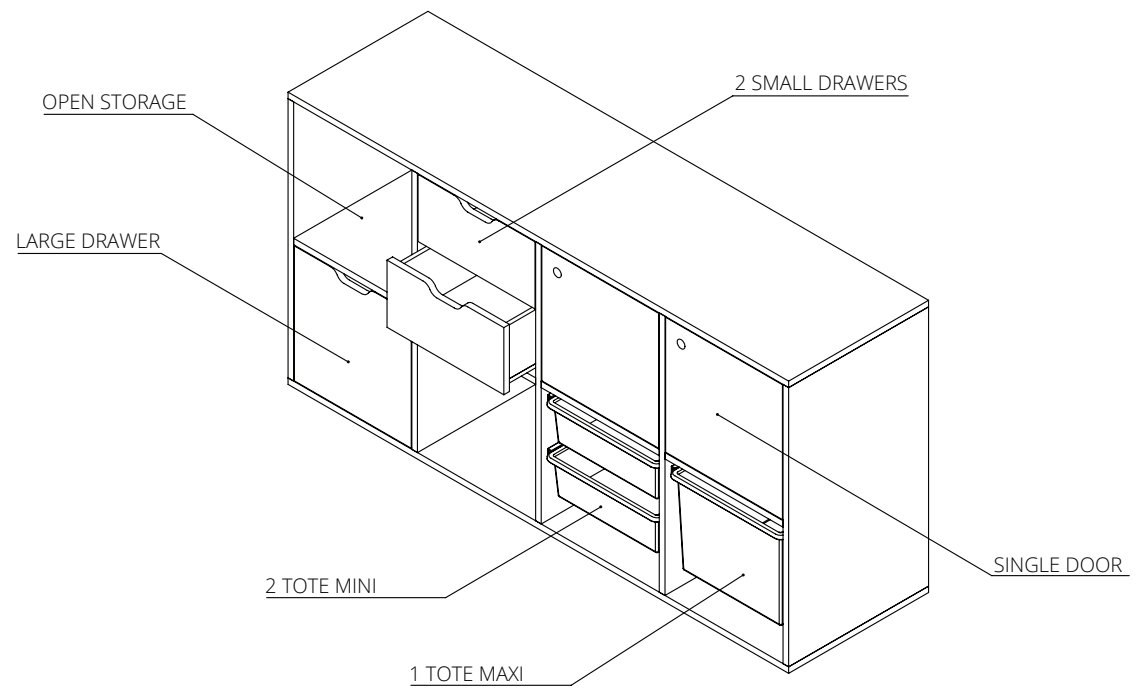

DESIGNED BY  
VE FURNITURE

# Maker Table Components

---

## MAKER ACCESS TABLE

---

Model: MAK001  
W1800 x D1200 x H720  
Model: MAK002  
W1800 x D1200 x H900

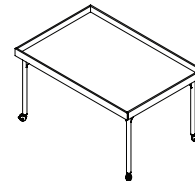

---

## MAKER ACTION TABLE

---

Model: MAK004  
W1800 x D1200 x H900

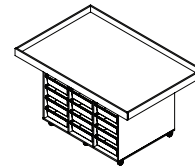

---

## MAKER EXPLORER TABLE

---

Model: MAK006  
W1800 x D1200 x H900

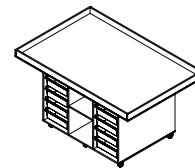

---

## MAKER ENGAGE TABLE

---

Model: MAK003  
W1800 x D1200 x H900

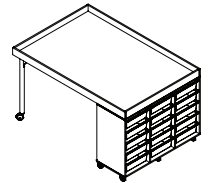

---

## MAKER PLANNER TABLE

---

Model: MAK005  
W1800 x D1200 x H900

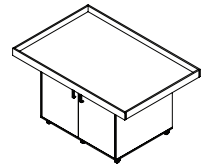

---

## MAKER ASSEMBLE TABLE

---

Model: MAK007  
W1800 x D1200 x H900

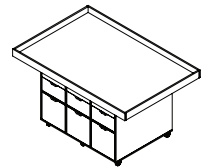

# Maker Table Components

---

## STOREWELL SINGLE DRAWER KIT

---

Model: STO008-KIT1  
W376 x D18 x H376  
Kit Includes 1x Drawer + Rails

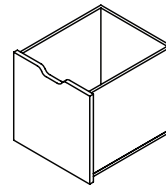

---

## STOREWELL MAXI TOTE KIT

---

Model: STO010-KIT3  
W365 x D420 x H270  
Kit Includes 1x Tote + Rails

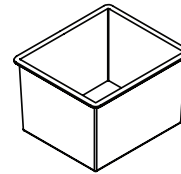

---

## STOREWELL SINGLE DOOR KIT

---

Model: STO012-KIT5  
W376 x D18 x H376  
Kit Includes 1x Door + Hinges

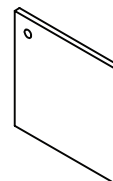

---

## STOREWELL DOUBLE DRAWER KIT

---

Model: STO009-KIT2  
W376 x D18 x H376  
Kit Includes 2x Drawer + Rails

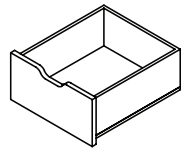

---

## STOREWELL MINI TOTE KIT

---

Model: STO011-KIT4  
W365 x D420 x H270  
Kit Includes 2x Tote + Rails

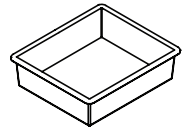

---

## SCRIBE TABLET WHITEBOARD

---

Model: SCR001  
W300 x D10 x H450  
Optional Storage Hook Available

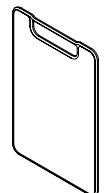

# Materials + Finishes

---

## STANDARD EO LAMINATE

---

Reflecting the most realistic timber grains and brilliant whites, this range has been curated to complement any fabric selection. 18 mm option available upon request.

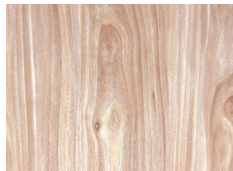

Natural Oak



Dark Oak



Storm

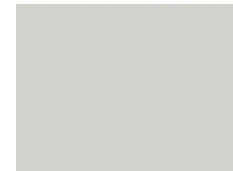

Grey

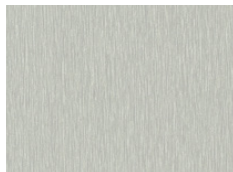

Zincworks



Diamond

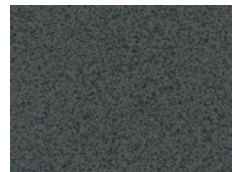

Ironstone

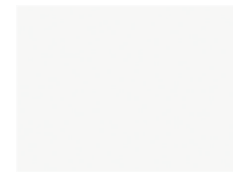

White

### Design Tip:

Try using a white surface with a coloured ABS edge to help introduce feature colours to your space.

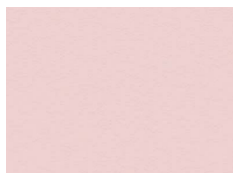

Just Rose



Peacock



Infinity



Gloss Writable

# Materials + Finishes

---

## LAMINATED PLYWOOD + PREMIUM TIMBER

---

Warm, soft and calming, this range has been curated to reduce stress and restore energy levels through its biophilic properties.



Natural Oak

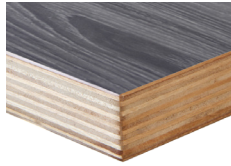

Dark Oak



White



Birch Plywood



Rubberwood



---

## SHIPPING

---

Shipping is calculated at the time of order. White Glove delivery and installation is extra. For more information, visit [vef.com.au](http://vef.com.au)

---

## FURNITURE WARRANTY

---

To initiate a claim, contact a helpful VE Furniture Account Representative by emailing [info@vef.com.au](mailto:info@vef.com.au) or calling 1300 966 640, Monday-Friday 9am to 5pm AEST.

For complete warranty information please visit [info.vef.com.au/warranty](http://info.vef.com.au/warranty)

---

## RETURNS + EXCHANGES

---

To place a return, please contact an Account Representative at [info@vef.com.au](mailto:info@vef.com.au) or give us a ring on 1300 96 66 40 within 30 days of receiving your goods from VE Furniture. Our Account Representatives will happily determine if the product can be returned or exchanged. White Glove Installation fees are non-refundable.

For more details on our Terms + Conditions, please visit [vef.com.au/terms-of-service](http://vef.com.au/terms-of-service)



Showroom + Design Centre  
69 - 75 Glenvale Crescent  
Mulgrave Vic 3170

**S H O W R O O M**

Phone : 1300 966 640

**P H O N E**

Info@vef.com.au  
www.vef.com.au

**O N L I N E**

